



23 Exhibition Drive, Malaga Western Australia

Monday - Friday 7am-5pm + Sat 8am-4pm

Sales Centre for Sales, Advice + Orders

T +61 8 9209 7400

[hello@beyondtools.com](mailto:hello@beyondtools.com)

## UNIVERSAL LATHE STAND 70-920 BY RIKON

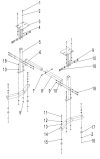

SKU	Option	Part #	Price
9803617		70-920	\$189

Model	
Type	Woodturning Lathe Stand
SKU	9803617
Part Number	70-920
Brand	Rikon
Dimensions	
Product Weight (Net Weight)	20 kg
Packaging + Shipping	
Shipping Length	668 mm
Shipping Width	485 mm
Shipping Height	261 mm
Shipping Weight (Gross)	22.75 kg
Shipping Notes	This product is classified as 'Heavy / Oversized' and generally does not qualify for FREE SHIPPING.

Enhance the stability and versatility of your lathe with the Universal Lathe Stand 70-920 by Rikon. Designed for durability and ease of use, this lathe stand is the perfect addition to any woodworking workshop.

### Features

Steel stand fits a variety of mini and midi lathe models

Length adjusts from 23-1/2" to 37-1/4"

Working height adjusts from 24-1/2" to 34-1/2" height from the ground

Top plates with pre-bored mounting holes measure 6-1/2" x 8-1/2"

### Suits

Rikon 70-220VSR Lathe

Similar Lathes