

750W ELECTRONIC TILTABLE TRIMMER FR292R BY VIRUTEX

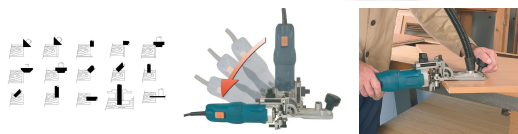

SKU	Option	Part #	Price
55123		FR292R / 9200200	\$669

Model	
Type	Trimmer
SKU	55123
Part Number	FR292R / 9200200
Barcode	8421752065871
Brand	Virutex
Dimensions	
Product Weight (Net Weight)	6.4 g
Packaging + Shipping	
Shipping Length	420 mm
Shipping Width	580 mm
Shipping Height	220 mm
Shipping Weight (Gross)	7.0 kg



The only trimmer capable of trimming the excess of the panel or edge surfaces flat or at any angle, without changing the bit. Its wide base provides effective guiding and easy trimming. It offers numerous additional trimming possibilities, thanks to the unique tilting and adjustment system. Equipped with a powerful 750 W motor with electronic speed adjustment and constant torque control for a constant motor speed under load. External dust collector connection.

Easier, more accurate trimming, with the special 90° bit The machine body can be tilted to approximately 46.5°, so that the edge of the bit is at 1.5° to the surface, preventing damage when trimming excess edges. Once the excess coating has been trimmed from the board surface (1), just position the bit at the level of the base to trim the excess edge level with the surface (2). By simply operating a single adjustment control, you can trim a further excess surface or edge. By tilting the machine to the horizontal position, you can trim 45° chamfered edges. You can also chamfer to the angle you require (A°) between 0° and 45°, by tilting the motor body to the required intermediate angle (45° + A° on the machine indicator)

Trimming with the straight bit The tiltable motor body permits the trimming of straight edges with the cylindrical bit as well as the excess surface. Excess panel is trimmed with the motor body in the vertical position, and edges with the motor body inclined to 91.5°, i.e. at 1.5° below the board surface, thereby avoiding damage